



# Reolink Argus

## Quick Start Guide

### Technical Support

**For advanced setup, please download the user manual:**  
<https://reolink.com/software-and-manual/>

**For more troubleshooting, please go to FAQs on our website:**  
<https://reolink.com/faqs/>

**For other technical support, please contact us at**  
[support@reolink.com](mailto:support@reolink.com)

Welcome to Reolink  
Easy Setup Within Minutes!

## What's in the Box



Reolink Argus Camera  
x1



Wall Mount  
x1



Outdoor Security Mount  
(with a hook & loop strap)  
x1



CR123A Batteries  
x4



Skin  
x1



Reset Needle  
x1



Surveillance Sign  
x1

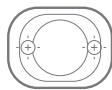

Mounting Hole  
Template  
x2



Screws (in pack)  
x2



Stick  
x1

## General Introduction

Micro SD Card Slot

Reset Hole

Daylight Sensor

Lens

Status LED

Built-in Mic

Built-in PIR Motion Sensor

Speaker

Wall Mount

The LED in Red (WiFi connection failed)  
Blinking: Standby status  
On: Working status

The LED in Blue (WiFi connection succeeded)  
Blinking: Standby status  
On: Working status



## Insert the Batteries into the Camera



### Step 1

Please use the stick to press the white button, and then rotate to separate the back casing from the camera.



### Step 2

Insert four batteries into the battery slot.



### Step 3

Close the back casing. Please press both ends of the casing to make it close firmly for good weather-proof performance.



## Important Safeguards on Battery Use

- The batteries must be placed in the right direction of polarity;
  - Do not use batteries of different brands and different models together;
  - Do not use new and old batteries together;
- If you don't use the product for long periods, please remove the batteries in avoidance of corrosion resulting from battery leakage.

### Reolink Argus Supports

- **3V** CR123A non-rechargeable batteries
- **3.6V~4.2V** CR123A rechargeable batteries

### Important Note

Reolink Argus is not designed for 24/7 full capacity running or around-the-clock live streaming. It's designed to record motion events and remotely view live streaming only when you need it. Please note that a new set of 4 batteries (the standard batteries we provide) will support up to 180 days in standby mode, or 840 minutes (IR LEDs off in daytime) of motion triggered recording and live view.

Please learn some useful ways to extend the battery life in this post:  
<https://reolink.com/faq/extend-battery-life/>

## Install Reolink App

There are two ways to get the Reolink App:

- Search "Reolink" in App Store (for iOS), or Google Play (for Android), download and install the app.
- Scan the QR code below to download and install the app.



## Set up the Camera

Please follow the prompt tone to configure the camera

// Camera has been started up. Please run Reolink App. Click the "Add New Device" button, and follow the instructions to set up the camera. //

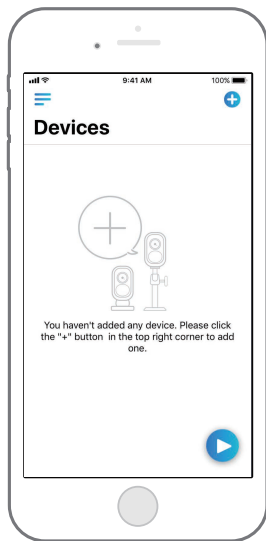

1. Please click the "+" button in the top right corner to add the camera.



2. Scan QR code on the camera.

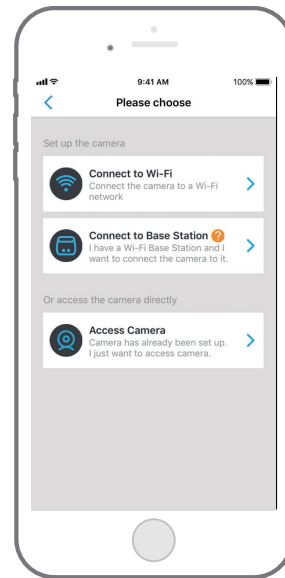

3. Click "Connect to Wi-Fi" to continue.

**Note 1:**  
Your family can click "Access Camera" for live view after the initial setup.

**Note 2:**  
If you have a Reolink Base, please follow the Quick Start Guide of the Base to add the camera. The Reolink Base is not included in the package.

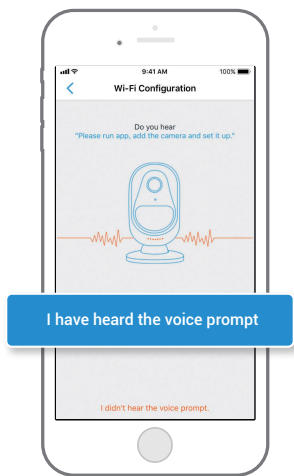

4. Click the button “I have heard the voice prompt” to enter the next page.

If you did not hear the voice prompt, please press “I did not hear the voice prompt” for help.

Distance (20cm)

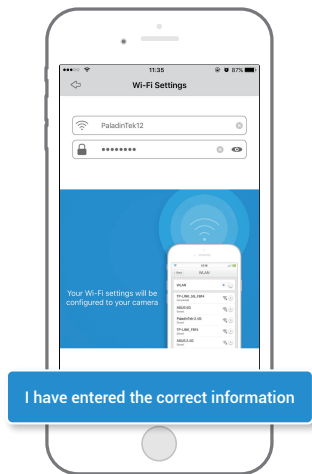

5. Enter the Wi-Fi password of the selected Wi-Fi network and press “I have entered the correct information” to enter the next page.

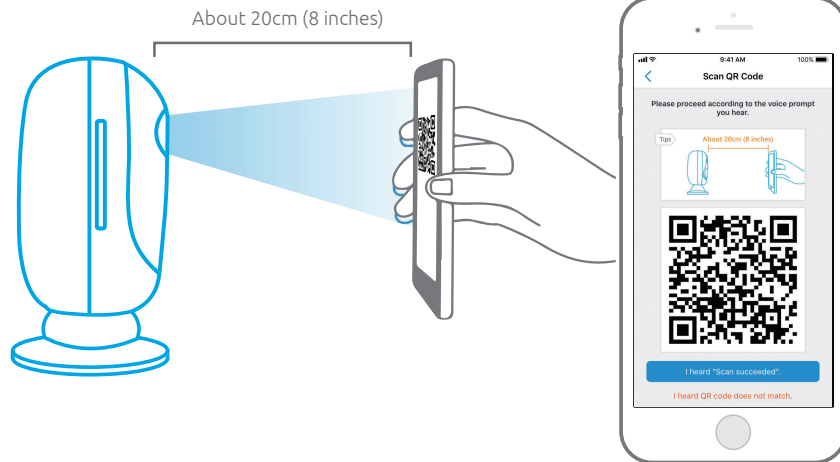

“ Scan succeeds. Camera is connecting to the router. ”

6. A QR code will be generated on the phone. Please place the QR code on your phone towards Reolink Argus camera's lens at a distance of about 20cm (8 inches) to let the camera scan the QR code. Please make sure that you've ripped the protection film of the camera's lens.

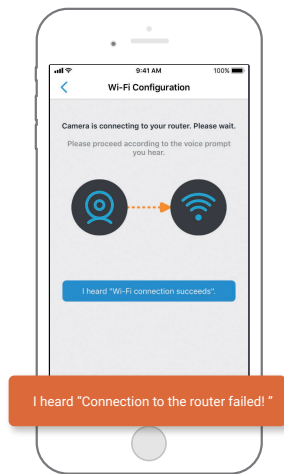

“ Connection to the router failed! ”

7. If you hear the above voice prompt, please press "I heard 'Connection to the router failed! ' " for help.

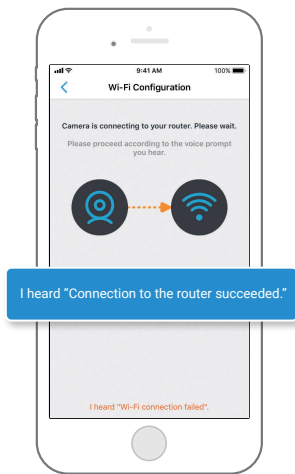

“ Connection to the router succeeded.  
Welcome to Reolink! ”

8. If you hear the above voice prompt, please press "I heard 'Connection to the router succeeded. ' " to finish the quick setup.

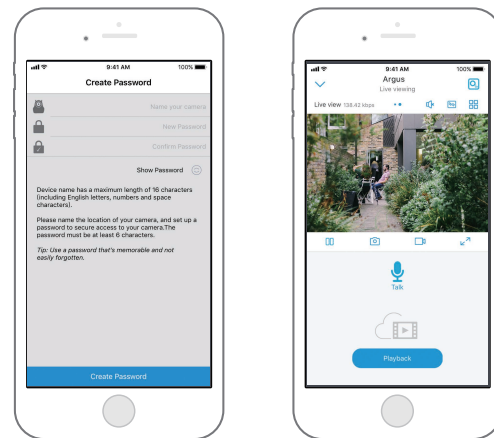

9. Name your camera and create a password (at least 6 characters), tap "Create Password", slide the page to read the tips and tap "finish" to start the Live View. Tap  to go to the "Devices" menu.

Note:



"Name your camera" field refers to the display name of the camera rather than the login username.

"Playback" only displays when you've inserted a micro SD card into the camera. Make sure that the SD card is recognized by the camera.

10. Please tap the camera and follow the steps to sync the time, and then start live view or go to "Device Settings" for more configurations.

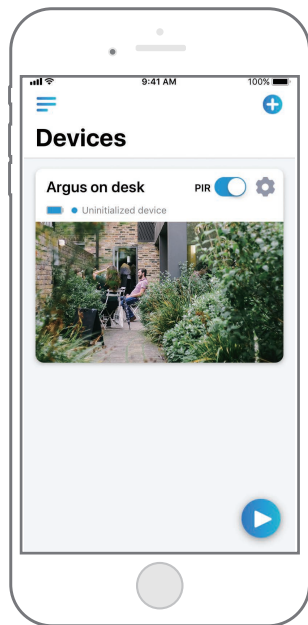

## Device Menu

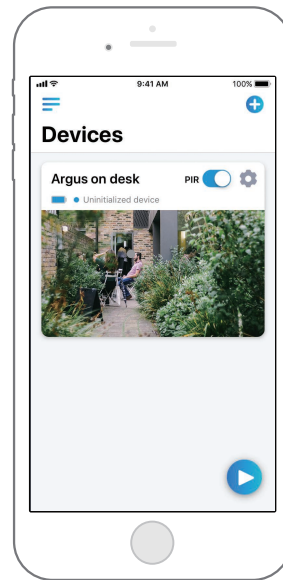

Menu



Add New Device



Enable/Disable PIR Motion Sensor  
(In default, the PIR sensor is enabled.)



Device Settings



Access the Live View



Battery Status



## Adjust the Detecting Distance of the PIR Sensor

The default sensitivity of the PIR sensor is at "Mid" and the detecting distance is 6 meters (20ft). If you want to adjust the sensitivity, please launch your Reolink App, and then click "Device Settings" -> "PIR Settings" and click the "save"  button to save the settings.

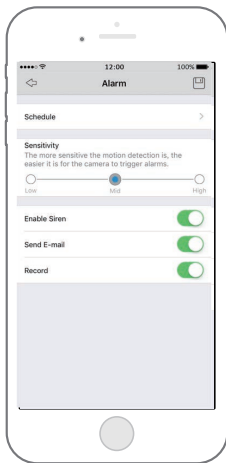

Sensitivity	Detecting Distance (For moving and living things)	Detecting Distance (For moving vehicles)
Low	Up to 4 meters (13ft)	Up to 10 meters (33ft)
Mid	Up to 6 meters (20ft)	Up to 12 meters (40ft)
High	Up to 9 meters (30ft)	Up to 15 meters (50ft)

### Note:

Higher sensitivity offers longer detecting distance, but it would lead to more false alarms.

You are advised to set up the sensitivity level to "Low" or "Mid" when you install the camera outdoors.



## Important Notes for Reducing False Alarms

### To reduce false alarms, please note that:

- Do not install the camera facing any objects with bright lights, including sunshine, bright lamp lights, etc.
- Do not place the camera too close to a place where there are frequently moving vehicles. Based on our numerous tests, the recommended distance between the camera and the vehicle is 15 meters (55ft).
- Stay away from the outlets, including the air conditioner vents, humidifier outlets, the heat transfer vents of projectors, etc.
- Do not install the camera facing the mirror.
- Keep the camera at least 1 meter away from any wireless devices, including Wi-Fi routers and phones in order to avoid wireless interference.

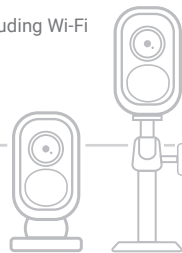

## Cover the Monitoring Area

When installing the camera, it's not suggested to make the PIR sensor vertically face the moving object. Please note that if the moving object approaches the PIR sensor vertically, the PIR sensor may not detect the motion events. You are advised to install the camera angularly (the angle between the PIR sensor and the detected object is larger than  $10^\circ$ ) for effective motion detection.

### FYI:

- The PIR sensor's detecting distance: 20ft (in default)
- The PIR sensor's detecting angle:  $120^\circ$  (H)

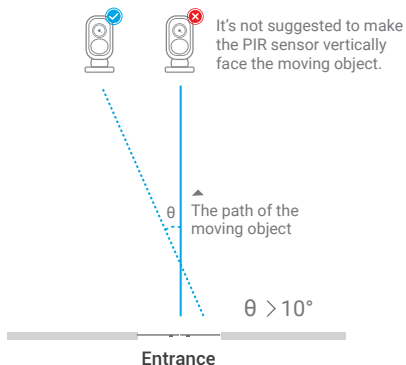

## The Ideal Viewing Distance

The ideal viewing distance is 2-10 meters (7-33ft), which enables you to recognize a human.

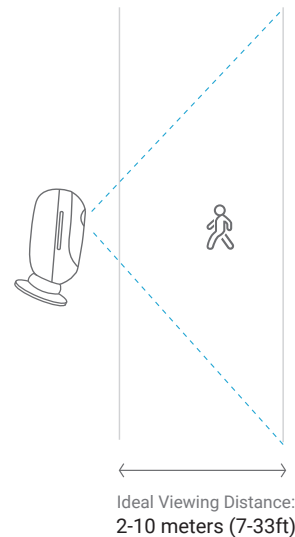

## How to Install Wall Mount

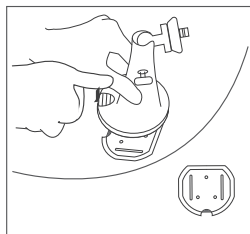

**Step 1**  
Press the button to release the plate from the security mount.

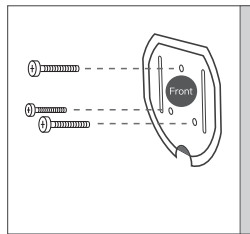

**Step 2**  
Screw the security mount plate into the wall.

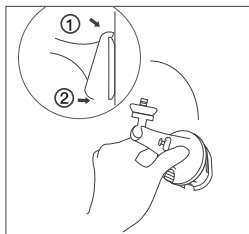

**Step 3**  
Latch the security mount on its plate. (Make sure the top edge of the backing plate is inserted into the mount.)

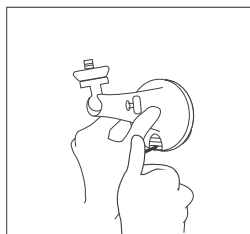

**Step 4**  
Press the security mount button until its plate clicks into the mount.

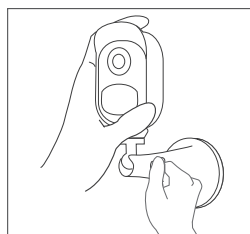

**Step 5**  
Screw the Argus, adjust its direction and tighten the knob to fix it.

## Tree Mount

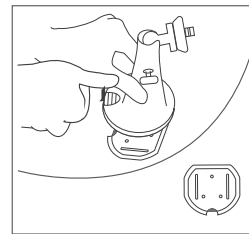

**Step 1**  
Press the button to release the plate from the security mount.

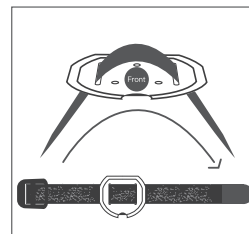

**Step 2**  
Thread the hook & loop strap through the slots.

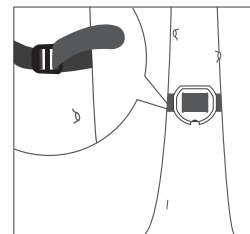

**Step 3**  
Fasten the warp strap to the tree.

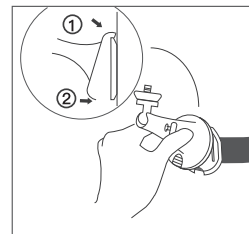

**Step 4**  
Latch the security mount on its plate (Make sure the top edge of the backing plate is inserted into the mount.)

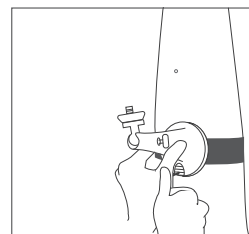

**Step 5**  
Press the security mount button until its plate clicks into the mount.

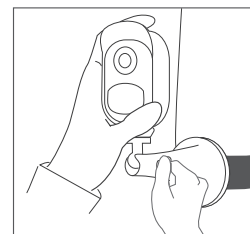

**Step 6**  
Screw the Argus, adjust its direction and tighten the knob to fix it.

## How to Remove

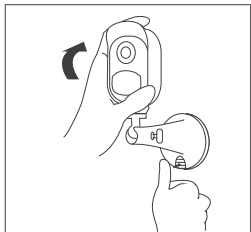

Step 1  
Press the security mount button  
to pull the mount out.

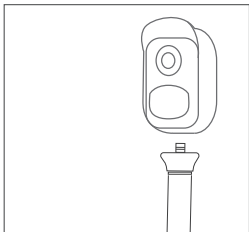

Step 2  
Unscrew the Argus from the wall mount.